



Product:

Camaro Sway Bar End Link Kit

Part Number:

1410108

Applications:

2010+ Camaro

Description:

High performance adjustable end link kit.

What's in the box:

RH Studded Rod Ends	4
LH Studded Rod Ends	2
LH Rod Ends	2
Short Turnbuckle	2
Long Turnbuckle	2
Hardware Bag	1
Flange Nuts	8
Washer	2
Bolt	2
RH Jam Nut	4
LH Jam Nut	4
Spacer	2

Difficulty of Installation: Beginner |-----x-----| **Advanced**

Reason: This product is simple to install, requiring no special tools and can be completed on jack stands.

Expected Installation Time: 45 minutes

Recommended Tools:

- T30 Torx Bit
- 15mm Box End Wrench
- 5/16" Allen Wrench
- 9/16" Open End Wrench
- 1/2" Open End Wrench

Installation Procedure

OE End Link Removal

1. Safely lift and support the car and remove the wheels.
2. Using the Torx Bit and 15mm wrench remove the nuts at each end of the OE end links.

Pfadt End Link Installation

General Instructions

Assemble the end links as shown in the following diagrams. Note which rod end attaches to the sway bar, strut and control arm as outlined in the installation diagrams. Initially set the length of the end links to the length shown. Pay careful attention to rod end alignment. If the ball in each rod end is not centered when tightening the jam nuts the front end links will loosen during steering, causing noise and potential end link failure. End link alignment should be set with the steering wheel centered.

End Link Setup

Disconnect the end link from the sway bar in the front and rear driver's side and loosen the jam nuts. Set the car on a level surface and roll back and forth to settle the suspension. Adjust the length of the end link by turning the turnbuckle until the end link can be easily installed through the sway bar with no tension. Tighten the jam nuts and torque the flange nuts attaching the end links to the sway bar. This removes the pre-load from the sway bar to maximize sway bar performance and consistency.

Torque for flange nuts = 35 ft-lbs

NOTE: To prevent thread galling, do not use a high-speed driver such as an impact gun on the flange nuts. Only tighten by hand and torque to spec.

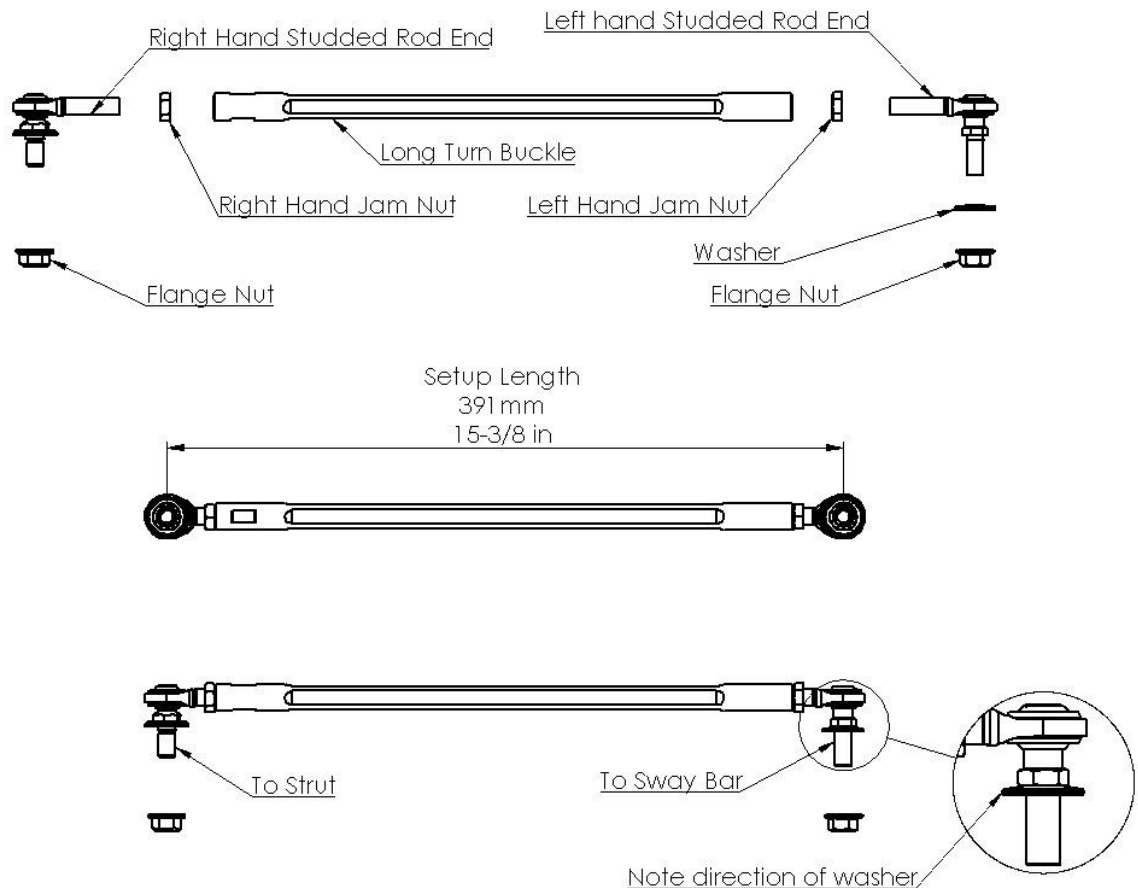

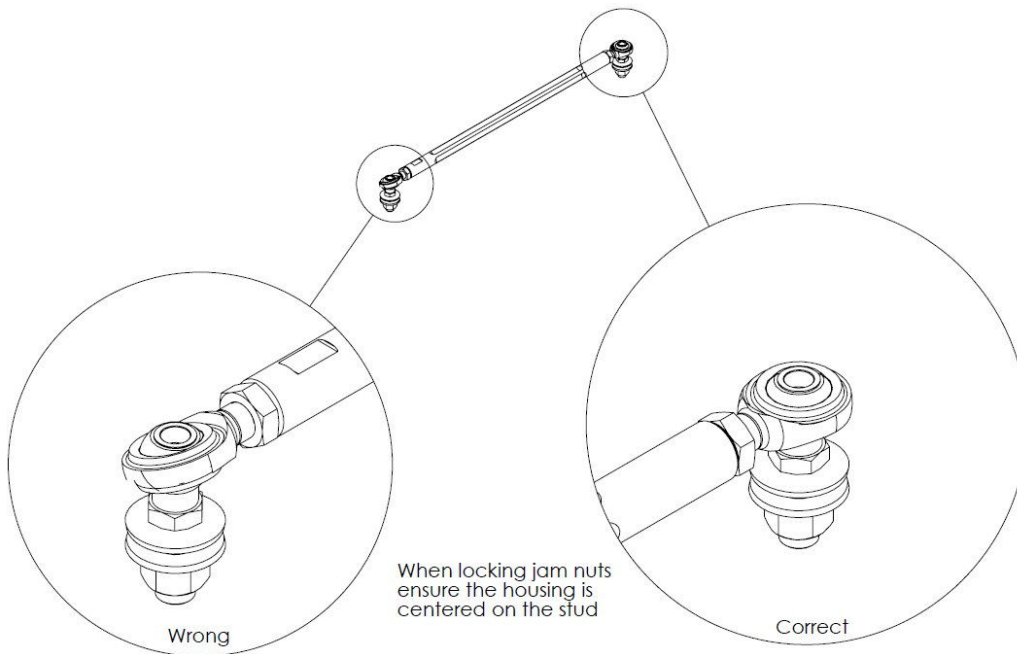
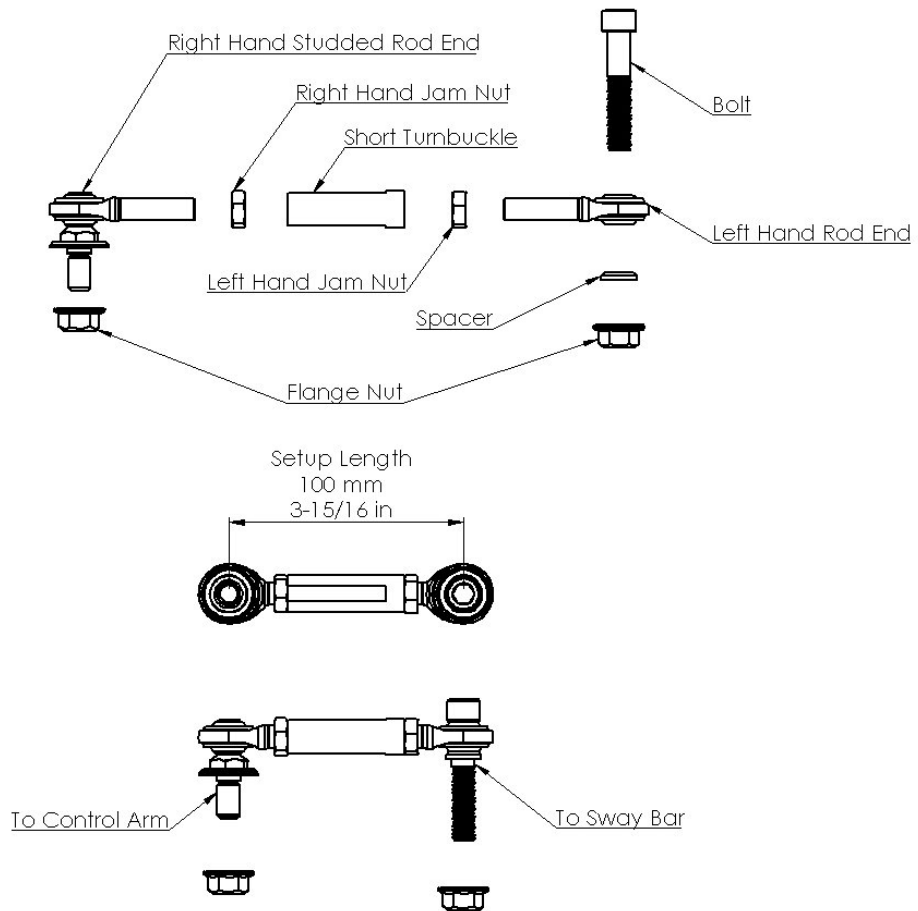



2315 Decker Lake Blvd.
Salt Lake City, UT 84119

888-972-2464
www.PfadtRacing.com